

GABLES PRIMARY SCHOOL

LANDSCAPE SCHEMATIC DESIGN



DRAWING SCHEDULE

SHEET	TITLE	DATE	REVISION	REVISION
L000	COVER SHEET	21.11.24	C	000
L001	LEGEND	21.11.24	C	000
L002	MATERIALS AND FINISHES SCHEDULE	21.11.24	C	000
L101	TREE RETENTION AND REMOVAL PLAN	21.11.24	C	100
L201	SURFACE FINISHES PLAN	16.10.24	B	200
L202	SURFACE FINISHES PLAN	16.10.24	B	200
L203	SURFACE FINISHES PLAN	21.11.24	C	200
L204	SURFACE FINISHES PLAN	21.11.24	C	200
L205	SURFACE FINISHES PLAN	21.11.24	C	200

NOTES

1. THIS DRAWING IS TO BE READ IN CONJUNCTION WITH ALL LANDSCAPE ARCHITECTURE SCHEDULES, TECHNICAL SPECIFICATIONS, AND OTHER CONSULTANT DRAWINGS. PLEASE CHECK AND VERIFY ALL DIMENSIONS AND SITE CONDITIONS PRIOR TO THE COMMENCEMENT OF ANY WORK. DO NOT SCALE DRAWINGS. REFER TO FIGURED DIMENSIONS ONLY. PLEASE INFORM OCULUS OF ANY DISCREPANCIES FOR CLARIFICATION BEFORE PROCEEDING. UNLESS OTHERWISE NOTED THIS DRAWING IS NOT FOR CONSTRUCTION. SERVICES SHOWN ON THIS DRAWING ARE APPROXIMATE ONLY. THE EXACT LOCATION IS TO BE CONFIRMED ON-SITE BY CONTRACTOR PRIOR TO COMMENCEMENT. DIAL BEFORE YOU DIG.

LEGEND

GENERAL

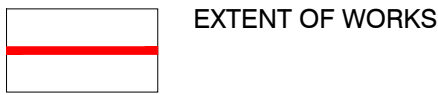

GRADING



PV - PAVING

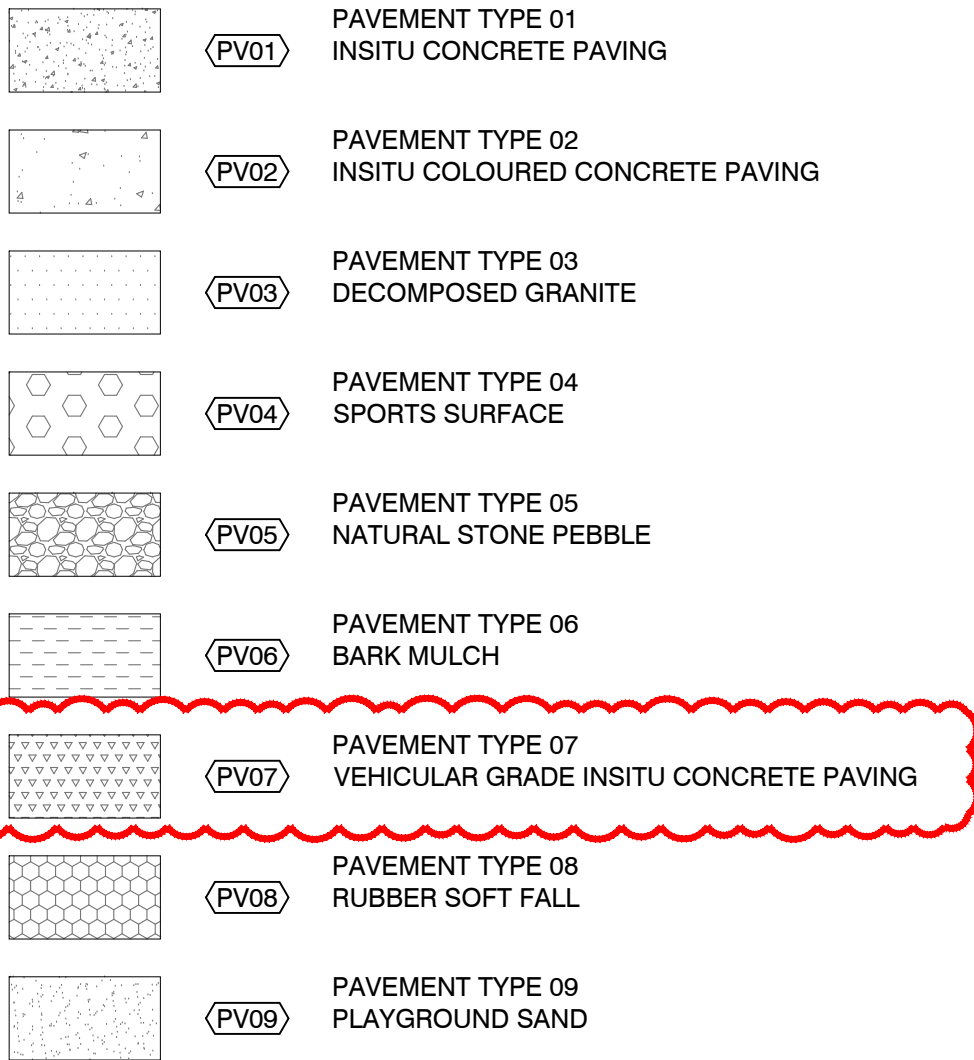

ED - EDGES

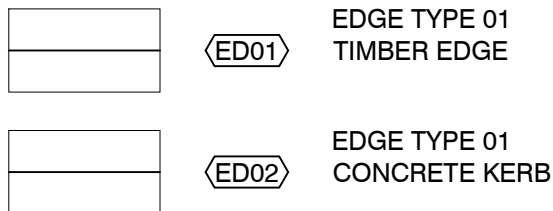

FN - FURNITURE

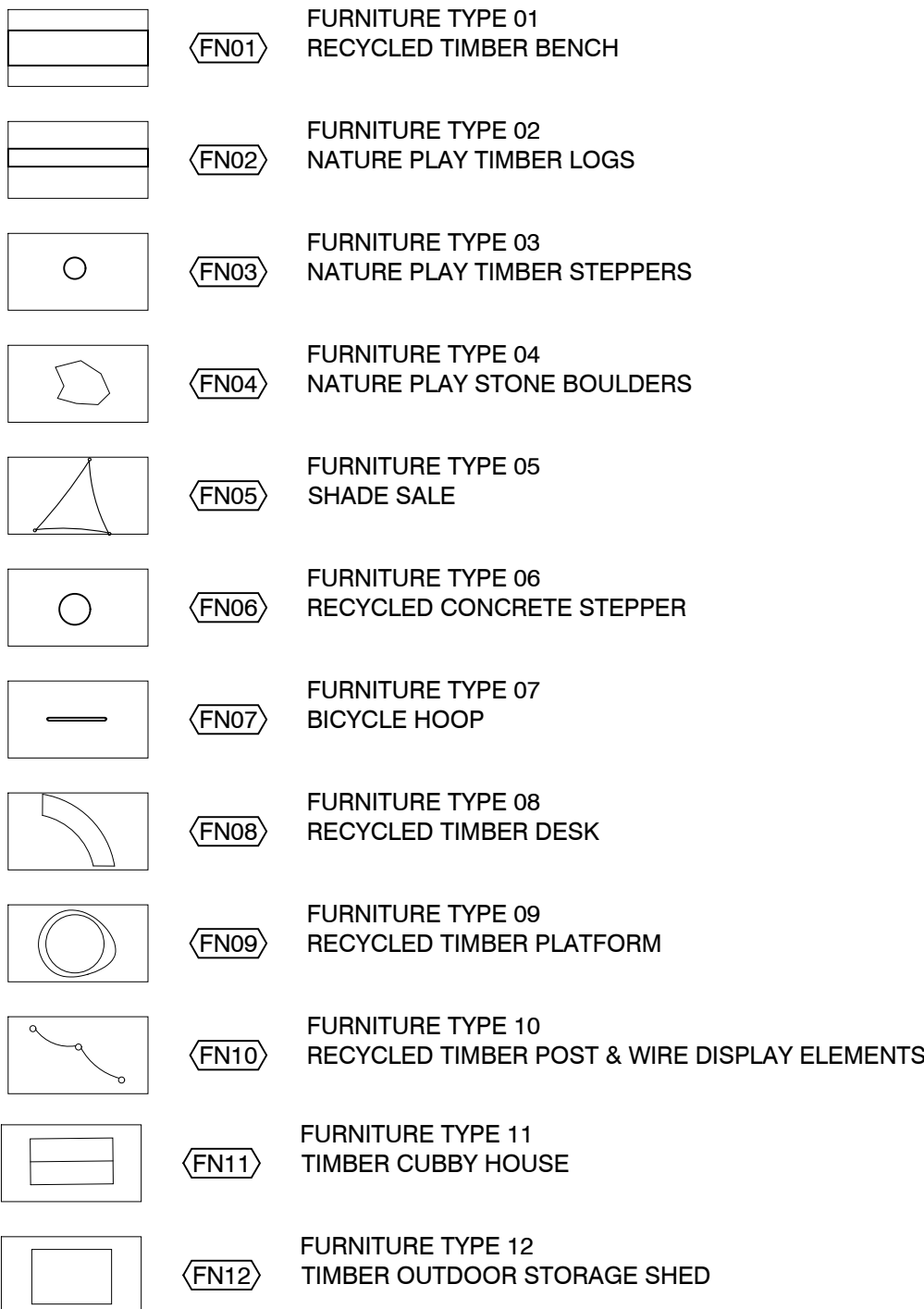

HR - HANDRAIL



FE - FENCES & GATES

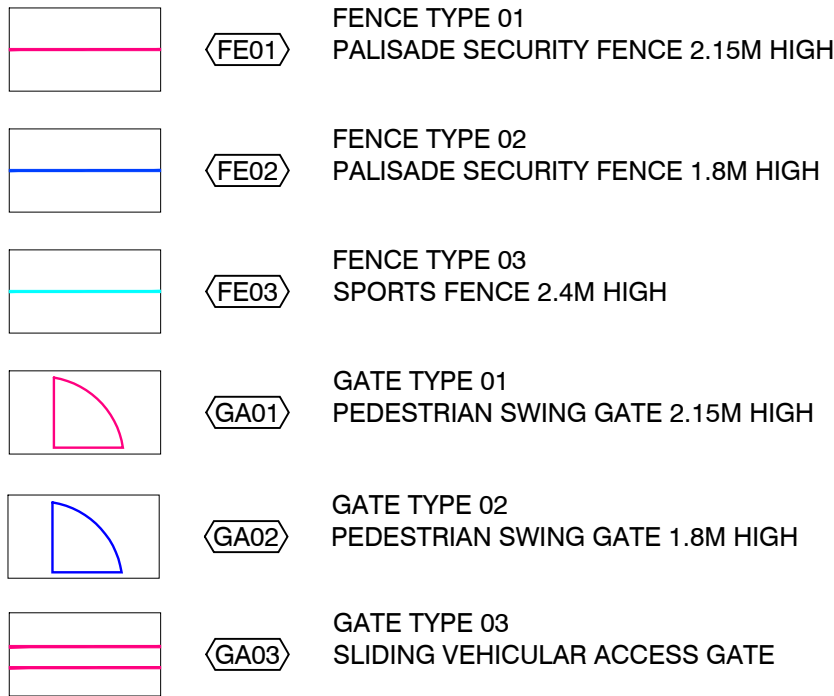

ST - STAIRS



MP - MASS PLANTING

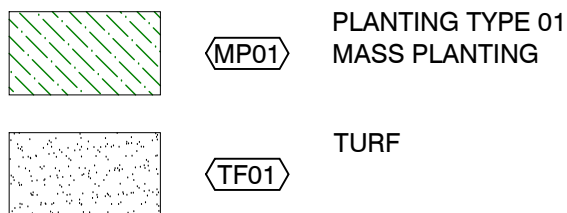

TP - TREE PLANTING

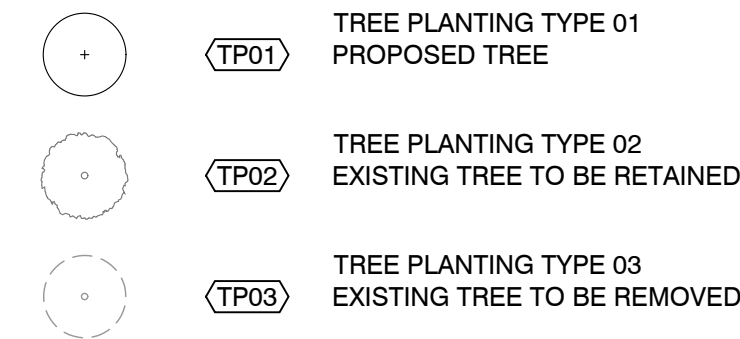

Gables Primary School - Materials Schedule

Code	Description	Details
Paving		
PV01	INSITU CONCRETE PAVING	100mm thick insitu concrete paving on grade. Finish: Broom finish Supplier: Holcim
PV02	INSITU COLOURED CONCRETE PAVING	100mm thick insitu coloured concrete. Sealed with two coats of CCS commercial grade Armourthane sealer. Finish: Broom finish Colour: CCS Terracotta full depth oxide
PV03	DECOMPOSED GRANITE	100mm depth, compacted and cement stabilised decomposed granite gravel laid on prepared base course and subgrade. Colour: Gold (NO CEMENT STABILISER WITHIN TREE TPZs)
PV04	ACRYLIC BASKETBALL COURT SURFACE	Mapei's Mapecoat Acrylic Surface Treatment to manufacturers instructions. Colour: TBC 1xNo 500x500mm samples panels displaying colour variance and depth of grit blasted finish required to be signed off by super intendant before supply and installation Supplier: Kangaroo Courts or approved equivalent
PV05	NATURAL STONE PEBBLE	200mm depth, 75-150mm diam spalls napean river pebble laid on prepared base course and subgrade. Supplier: Australian Native Landscapes
PV06	SOFTFALL BARK MULCH ON GRADE	Softfall Bark Play mulch. Supplier: Australian Native Landscapes
PV07	VEHICULAR GRADE INSITU CONCRETE PAVING	150mm thick insitu concrete paving on grade. Refer civil engineer's documentation. Finish: Trowel finish Supplier: Holcim
PV08	RUBBER SOFTFALL	Rubber wetpour with attenuation layer as per manufacturers recommendations to extent of fall zone shown on drawings. Colour: Mix Rosehill TPV - TBC Supplier: Surfacedesigns.com.au
PV09	PLAYGROUND SAND	600mm depth of tripled washed fine sand. Supplier: Sydney Landscape Supplies

Edges, Fences, & Stairs		
ED01	TIMBER EDGE	100(h) x 50(w) mm timber edging, fixed to 50 x 38 x 300mm long pegs on garden sides of edge. Timber to be termite resistant.
ED02	CONCRETE EDGE	150(h) x 100(w) mm insitu concrete kerb. Supplier: Holcim
FE01	PALISADE SECURITY FENCE (2.15m)	2150mm high Steel Palisade Security Fence. Concrete footings. Finish: Hot dipped galvanised and powdercoat black perimeter fence Supplier: Blue Dog Fences
FE02	PALISADE SECURITY FENCE (1.8m)	1800mm high Steel Palisade Security Fence. Concrete footings. Finish: Hot dipped galvanised and powdercoat black fence Supplier: Blue Dog Fences
FE03	SPORTS FENCE (2.4m)	2400mm chainwire multi-purpose sports fence. Concrete footings. Finish: Hot dipped galvanised and PVC coated chainwire multi-purpose sports fence. Supplier: Summit fencing
GA01	PEDESTRIAN SWING GATE (2.15m)	Double/single swing gate to match FE01 Palisade Security Fence. Refer to Architect's documentation for detail and specification.
GA02	PEDESTRIAN SWING GATE (1.8m)	Single swing gate to match FE02 Palisade Security Fence. Refer to Architect's documentation for detail and specification.
GA03	SLIDING VEHICULAR ACCESS GATE (2.15m)	Sliding vehicular access gate. Refer to Architect's documentation for detail and specification.
ST01	INSITU CONCRETE STAIR	Cast insitu concrete stairs. Ensure slip resistance compliance and class 2 finish to riser, each tread to have contrasting nose strip as per detail, to AS1428. Finish: Broom finish
TA01	TACTILE INDICATORS TGSIs	Safespot 'Luna' ribbed stainless steel taciles with ribbed polymer black centre infill to AS1428. Finish: Brushed 304 Stainless Steel Supplier: Safespot
HR01	HANDRAIL TO STAIRS	40mm dia stainless steel with 40mm dia stainless steel uprights as per details TBC. Handrail to AS1428. Finish: Brushed 304 Stainless Steel Supplier: Moddex Sydney

Structures & Furniture		
FN01	RECYCLED TIMBER BENCH	Recycled timber bench. Sizes: Length varies: 2000 - 10,000mm Typical width 500mm Height varies 350 mm from FFL
FN02	NATURE PLAY TIMBER LOGS	Recycled timber logs. Sizes: Diameter varies 200 - 500mm Length varies - 1000 - 3000mm
FN03	NATURE PLAY TIMBER STEPPERS	Recycled timber steppers. Sizes: Diameter varies 200 - 400mm Height varies 100-350mm from FFL
FN04	NATURE PLAY STONE BOULDERS	Sandstone boulders in random sizes. Laid partially buried in compacted subgrade with natural quarried profile. Any exposed sharp edges to be smoothed and rounded off. Finish: Natural Sizes: Diameter varies 500-1500mm Height varies max 600mm from FFL
FN05	SHADE SALE	Commercial 95340 Shade Fabric and C350 Grade Steel Post. Supplier: Sydney Shade Sails
FN06	RECYCLED CONCRETE STEPPER	Recycled concrete stepper. Sizes: Diameter varies 200-500mm Flush with surrounds
FN07	BICYCLE HOOP	Semi Hoop on insitu concrete base. Finish: Brushed 304 Stainless Steel Supplier: Street Furniture Australia Mounting: Subsurface Fixed
FN08	TIMBER DESK	Recycled timber curved desk. Size: Typical length 3000mm Typical width 600mm Typical height 600mm from FFL
FN09	TIMBER PLATFORM	Recycled timber circular platform. Size: Diameter varies 2400 - 3200mm Typical height 350mm from FFL
FN10	TIMBER POST & WIRE ART DISPLAY ELEMENTS	Recycled timber posts 1800mm high. Concrete footings. Stainless steel cable between posts at various heights, with stainless steel pegs.
FN11	TIMBER CUBBY HOUSE	4500 x 2500 timber cubby house. Finish: Hardwood timber Supplier: TBC
FN12	TIMBER OUTDOOR STORAGE SHED	5000 x 3600mm timber outdoor storage shed. Finish: Hardwood timber Supplier: TBC

Soft Landscaping		
TF01	TURF	Turf on grade.
TP01	PROPOSED TREE	Tree planting on grade.
TP02	EXISTING TREE TO BE RETAINED	Tree to be retained.
TP03	EXISTING TREE TO BE REMOVED	Tree to be removed.
MP01	MASS PLANTING	Mass planting on grade with hardwood chip mulch.

EXISTING TREE LEGEND

EXTENT OF WORKS

TP02

TREE PLANTING TYPE 02
EXISTING STREET TREE TO
BE RETAINED

TP03

TREE PLANTING TYPE 03
EXISTING STREET TREE TO BE
REMOVED SUBJECT TO TREE
REMOVAL PERMIT TO COUNCIL

The diagram is a key plan of a site. A red line outlines the 'EXTENT OF WORKS'. The site is bounded by 'PENNANT WAY' to the north, 'CATARACT ROAD' to the east, and 'CATARACT CREEK' to the south. To the west of the site are 'RESIDENTIAL HOUSES'. A 'FUTURE RECREATION RESERVE' is located to the north of Pennant Way. Several 'PROPOSED FUTURE PEDESTRIAN CROSSING' locations are marked with dashed lines and labels. 'PROPOSED DRIVEWAY LOCATION' is marked with arrows. Existing trees are represented by circles with a central dot. Two specific trees are highlighted with red dashed circles and labeled 'EXISTING STREET TREE TO BE REMOVED SUBJECT TO TREE REMOVAL PERMIT TO COUNCIL'. A group of trees along Cataraact Road is labeled 'EXISTING STREET TREES TO BE RETAINED AND PROTECTED WHERE POSSIBLE'. A small 'UP' label is located on Pennant Way.

OCULUS

architectus™

oculus.info
ABN 34 074 882 447

This drawing is to be read in conjunction with all landscape architecture schedules, technical specifications, and other consultant drawings. Please check and verify all dimensions and site conditions prior to the commencement of any work. Do not scale drawings – refer to figured dimensions only. Please inform OCULUS of any discrepancies for clarification before proceeding. Unless otherwise noted this drawing is not for construction. Services shown on this drawing are approximate only, the exact location is to be confirmed on-site by contractor prior to commencement – before you dig (byda.com.au).
© 2024

KEY PLAN

SCALE
1:500 @ A1

15 0 5 10 30m

PROJECT S22-028
GABLES PRIMARY SCHOOL
LOT 301 FONTANA DRIVE,
GABLES (BOX HILL NORTH), NSW 2765
STATUS
FOR INFORMATION
CLIENT
ARCHITECTUS
ARCHITECT
ARCHITECTUS

ISSUE	DATE	AMENDMENT	BY	APPROVED
A	04.10.24	100% SCHEMATIC DESIGN	FC	SC
B	16.10.24	100% SCHEMATIC DESIGN	FC	KS
C	21.11.24	100% SCHEMATIC DESIGN	SC	KS

DRAWING TITLE
TREE RETENTION AND REMOVAL
PLAN

DRAWING NUMBER
L101

REVISION
C



This drawing is to be read in conjunction with all landscape architecture schedules, technical specifications, and other consultant drawings. Please check and verify all dimensions and site conditions prior to the commencement of any work. Do not scale drawings – refer to figured dimensions only. Please inform OCULUS of any discrepancies for clarification before proceeding. Unless otherwise noted this drawing is not for construction. Services shown on this drawing are approximate only, the exact location is to be confirmed on-site by contractor prior to commencement – before you dig (byda.com.au).
© 2024

KEY PLAN

SCALE
1:500 @ A1

15 0 5 10 30m



PROJECT S22-028
GABLES PRIMARY SCHOOL
LOT 301 FONTANA DRIVE,
GABLES (BOX HILL NORTH), NSW 2765
STATUS
FOR INFORMATION
CLIENT
ARCHITECTUS
ARCHITECT
ARCHITECTUS

ISSUE	DATE	AMENDMENT	BY	APPROVED
A	04.10.24	100% SCHEMATIC DESIGN	FC	SC
B	16.10.24	100% SCHEMATIC DESIGN	FC	KS

DRAWING TITLE
SURFACE FINISHES
DRAWING NUMBER
L201
REVISION
B

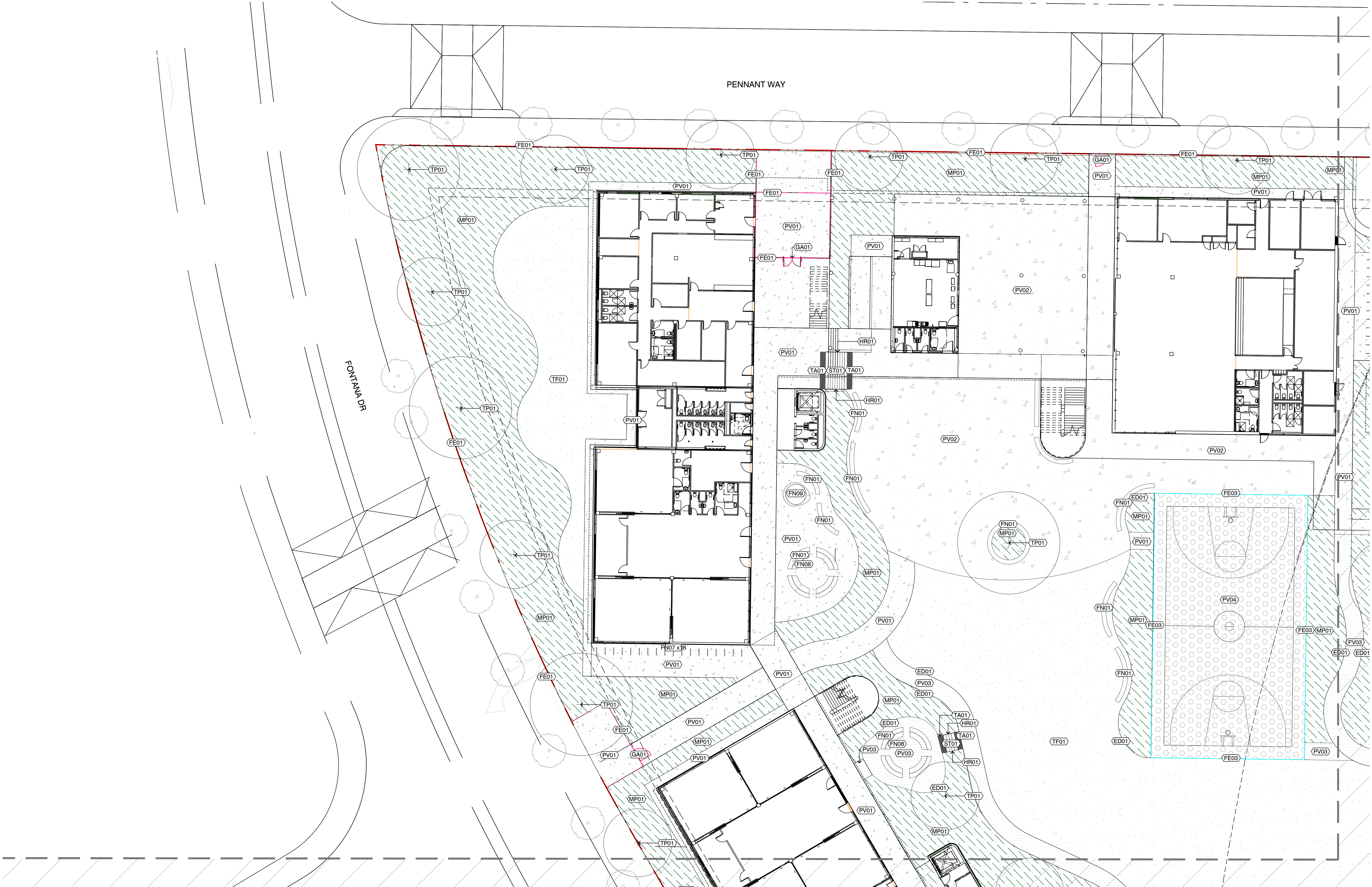

This drawing is to be read in conjunction with all landscape architecture schedules, technical specifications, and other consultant drawings. Please check and verify all dimensions and site conditions prior to the commencement of any work. Do not scale drawings – refer to figured dimensions only. Please inform OCULUS of any discrepancies for clarification before proceeding. Unless otherwise noted this drawing is not for construction. Services shown on this drawing are approximate only, the exact location is to be confirmed on-site by contractor prior to commencement – before you dig (byda.com.au). © 2024

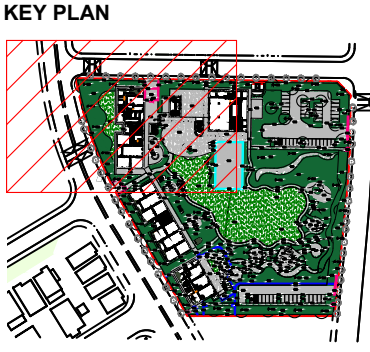

SCALE
1:200 @ A1

0 2 0 2 4 10m



PROJECT S22-028
GABLES PRIMARY SCHOOL
LOT 301 FONTANA DRIVE,
GABLES (BOX HILL NORTH), NSW 2765
STATUS
FOR INFORMATION
CLIENT
ARCHITECTUS
ARCHITECT
ARCHITECTUS

ISSUE	DATE	AMENDMENT	BY	APPROVED
A	04.10.24	100% SCHEMATIC DESIGN	FC	SC
B	16.10.24	100% SCHEMATIC DESIGN	FC	KS

DRAWING TITLE
SURFACE FINISHES
DRAWING NUMBER
L202
REVISION
B

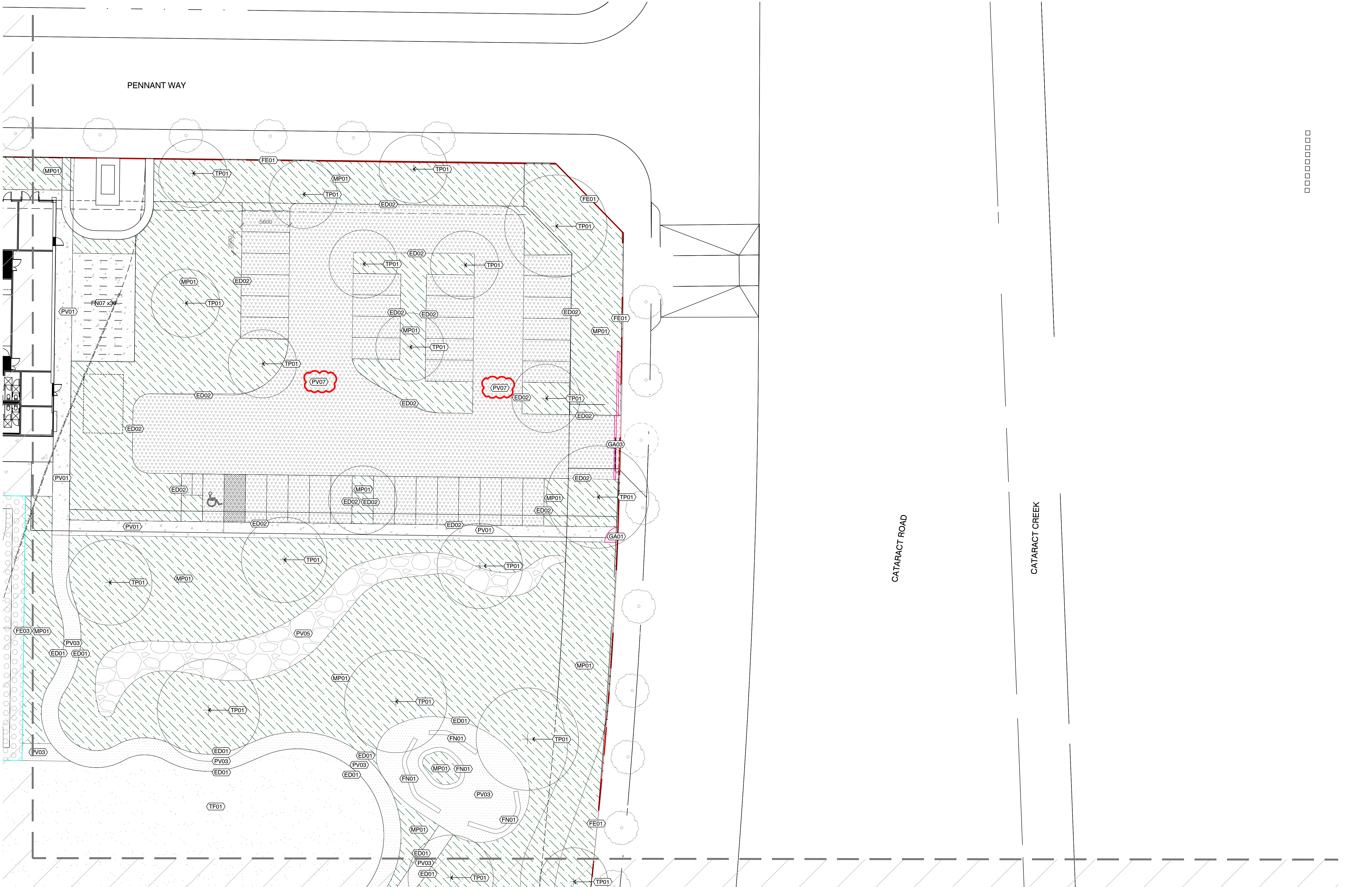

This drawing is to be read in conjunction with all landscape architecture schedules, technical specifications, and other consultant drawings. Please check and verify all dimensions and site conditions prior to the commencement of any work. Do not scale drawings – refer to figured dimensions only. Please inform OCULUS of any discrepancies for clarification before proceeding. Unless otherwise noted this drawing is not for construction. Services shown on this drawing are approximate only, the exact location is to be confirmed on-site by contractor prior to commencement – before you dig (byda.com.au). © 2024

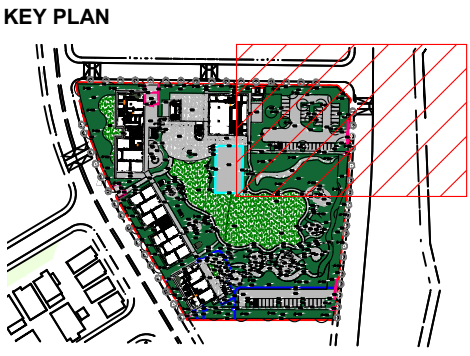

SCALE
1:200 @ A1



PROJECT S22-028
GABLES PRIMARY SCHOOL
LOT 301 FONTANA DRIVE,
GABLES (BOX HILL NORTH), NSW 2765
STATUS
FOR INFORMATION
CLIENT
ARCHITECTUS
ARCHITECT
ARCHITECTUS

ISSUE	DATE	AMENDMENT	BY	APPROVED
A	04.10.24	100% SCHEMATIC DESIGN	FC	SC
B	16.10.24	100% SCHEMATIC DESIGN	FC	KS
C	21.11.24	100% SCHEMATIC DESIGN	FC	KS

DRAWING TITLE
SURFACE FINISHES

DRAWING NUMBER
L203

REVISION
C

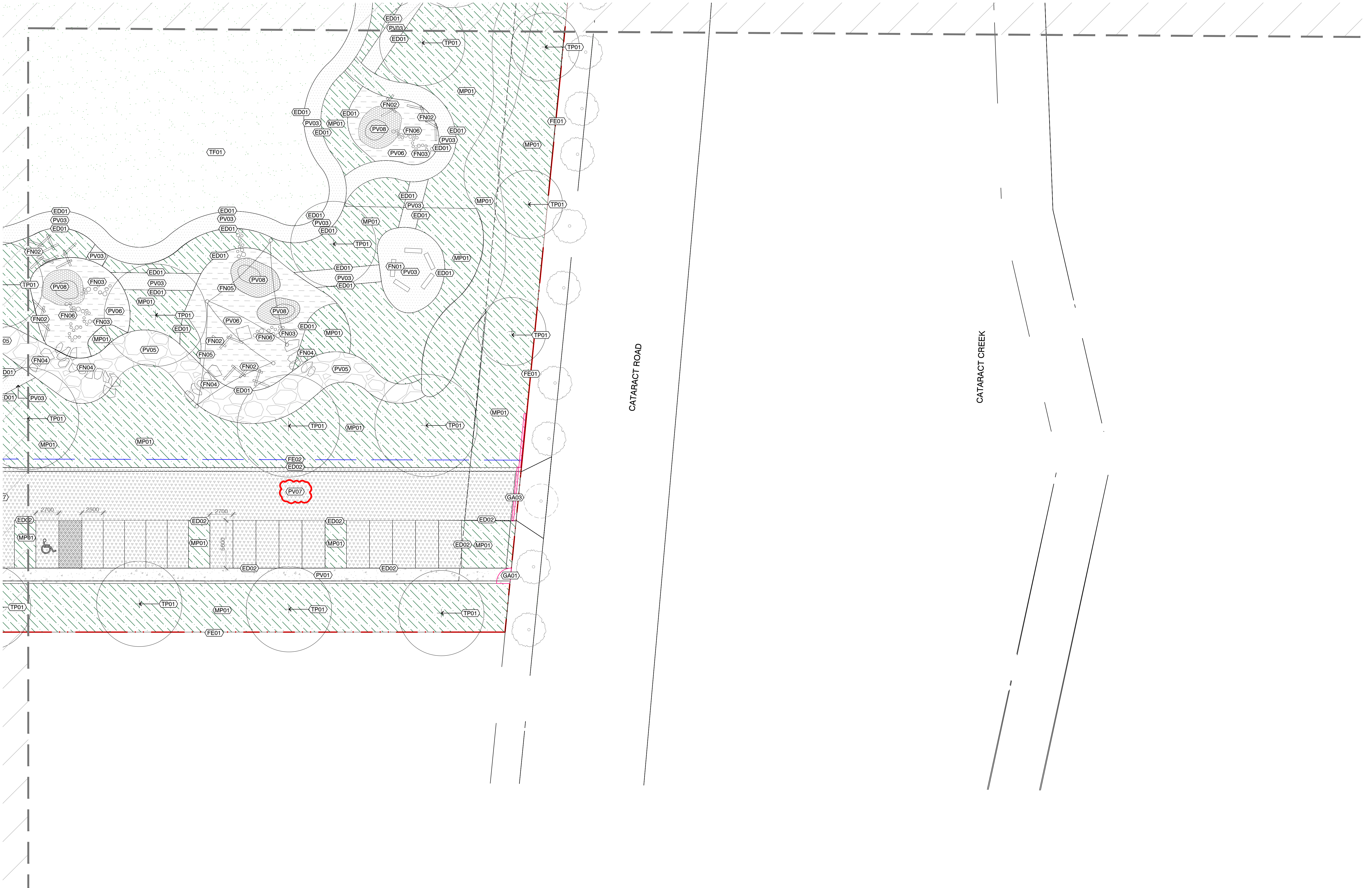

This drawing is to be read in conjunction with all landscape architecture schedules, technical specifications, and other consultant drawings. Please check and verify all dimensions and site conditions prior to the commencement of any work. Do not scale drawings – refer to figured dimensions only. Please inform OCULUS of any discrepancies for clarification before proceeding. Unless otherwise noted this drawing is not for construction. Services shown on this drawing are approximate only, the exact location is to be confirmed on-site by contractor prior to commencement – before you dig (byda.com.au). © 2024

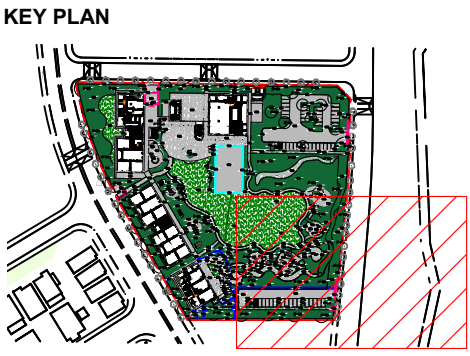

SCALE
1:200 @ A1



PROJECT S22-028
GABLES PRIMARY SCHOOL
LOT 301 FONTANA DRIVE,
GABLES (BOX HILL NORTH), NSW 2765
STATUS
FOR INFORMATION
CLIENT
ARCHITECTUS
ARCHITECT
ARCHITECTUS

ISSUE	DATE	AMENDMENT	BY	APPROVED
A	04.10.24	100% SCHEMATIC DESIGN	FC	SC
B	16.10.24	100% SCHEMATIC DESIGN	FC	KS
C	21.11.24	100% SCHEMATIC DESIGN	FC	KS

DRAWING TITLE
SURFACE FINISHES

DRAWING NUMBER
L205

REVISION
C